



- Quarter Turn Locks
- Compression Locks & Latches
- Handle Locks
- Rod Control Locks
- Electronic Locks
- Canopy Locks, Handles & Door Stay
- Hinges
- 9 Fold Accessories
- Sealing Profiles
- Fan Filter
- Panel Fasteners
- Sleeve & Termination
- Wiring Accessories
- Connectors

BGQ Quick Conduit Connector



Thread:Metric
 Material:NYLON66
 Certificates:CE,ROHS
 Fireproof rate:UL94V-2
 Color:Black-B
 Work temperature:-40°C to 85°C
 Features:Install or discharge without tools,just insert or output the conduit
 Remarks:Come with lock nut,but without washer, need to buy separately

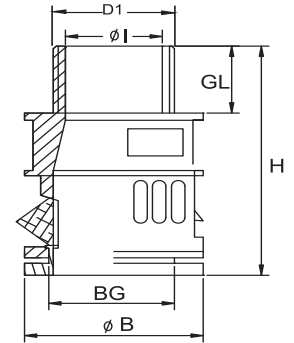

Unit:mm

| Item No. | Thread | Tubing outer BG | Thread O.D. D1 | Panel Mounting Hole | Thread Length GL | Smallest inner $\varnothing I$ | Largest outer $\varnothing B$ | Total length H | Packing pcs |
|---------------------|---------|-----------------|----------------|---------------------|------------------|--------------------------------|-------------------------------|----------------|-------------|
| Metric thread BGQ-M | | | | | | | | | |
| BGQ-M12B(BG07) | M12×1.5 | BG-07 | 12 | 12-12.3 | 10 | 7 | 17.0 | 32.5 | 100PCS |
| BGQ-M16B(BG10) | M16×1.5 | BG-10 | 16 | 16-16.3 | 10 | 12 | 20.0 | 32.5 | |
| BGQ-M18B(BG12) | M18×1.5 | BG-12 | 18 | 18-18.3 | 10 | 10 | 23.0 | 37.0 | |
| BGQ-M20B(BG15) | M20×1.5 | BG-15 | 20 | 20-20.3 | 11 | 13 | 25.5 | 40.0 | 50PCS |
| BGQ-M20B(BG17) | M20×1.5 | BG-17 | 20 | 20-20.3 | 12 | 15 | 29.5 | 43.5 | |
| BGQ-M25B(BG23) | M25×1.5 | BG-23 | 25 | 25-25.4 | 12 | 20 | 37.0 | 46.0 | 25PCS |
| BGQ-M32B(BG29) | M32×1.5 | BG-29 | 32 | 32-32.4 | 12 | 30 | 44.0 | 48.0 | |
| BGQ-M40B(BG36) | M40×1.5 | BG-36 | 40 | 40-40.4 | 12 | 35 | 51.5 | 50.0 | 10PCS |
| BGQ-M50B(BG48) | M50×1.5 | BG-48 | 50 | 50-50.4 | 12 | 36 | 51.5 | 50.0 | |
| BGQ-M63B(BG48) | M63×1.5 | BG-48 | 63 | 63-63.4 | 15 | 48 | 65.5 | 54.0 | |



BGQ Quick Conduit Connector



Thread:Metric:PG,NPT,G
 Material:NYLON66
 Certificates:CE,ROHS
 Fireproof rate:UL94V-2
 Color:Black-B
 Work temperature:-40°C to 85°C
 Features:Install or discharge without tools,just insert or output the conduit
 Remarks:Come with lock nut,but without washer, need to buy separately

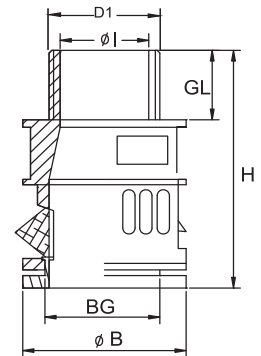

Unit:mm

| Item No. | Thread | Tubing outer BG | Thread O.D. D1 | Panel Mounting Hole | Thread Length GL | Smallest inner $\varnothing I$ | Largest outer $\varnothing B$ | Total length H | Packing pcs |
|----------------------|--------|-----------------|----------------|---------------------|------------------|--------------------------------|-------------------------------|----------------|-------------|
| Germany thread BGQ-P | | | | | | | | | |
| BGQ-PG7B(BG07) | PG7 | BG-07 | 12.5 | 12.5-12.8 | 10 | 7 | 20.0 | 32.5 | 100PCS |
| BGQ-PG9B(BG10) | PG9 | BG-10 | 12.5 | 15.2-15.5 | 10 | 7 | 20.0 | 32.5 | |
| BGQ-PG11B(BG12) | PG11 | BG-12 | 15.2 | 18.6-18.9 | 10 | 13 | 23.0 | 37.0 | |
| BGQ-PG13.5B(BG15) | PG13.5 | BG-15 | 20.4 | 20.4-20.7 | 11 | 14 | 25.5 | 40.0 | 50PCS |
| BGQ-PG16B(BG17) | PG16 | BG-17 | 22.5 | 22.5-22.8 | 12 | 16 | 29.5 | 43.5 | |
| BGQ-PG21B(BG23) | PG21 | BG-23 | 28.3 | 28.3-28.7 | 12 | 24 | 37.0 | 46.0 | |
| BGQ-PG29B(BG29) | PG29 | BG-29 | 37.0 | 37.0-37.4 | 12 | 30 | 44.0 | 48.5 | |
| BGQ-PG36B(BG36) | PG36 | BG-36 | 47.0 | 47.0-47.4 | 12 | 37 | 51.5 | 50.5 | |
| BGQ-PG48B(BG48) | PG48 | BG-48 | 59.3 | 59.3-54.7 | 15 | 48 | 65.5 | 54.0 | |

