



Self-Clinch Nuts

Zinc Plated Steel : AR-S | Stainless Steel : AR-CLS |



Material :
Steel & Stainless Steel

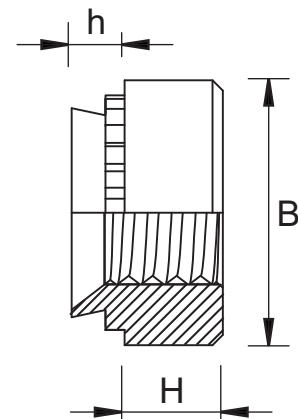
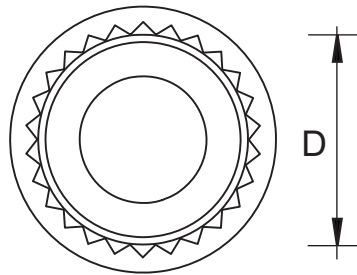

Metric Dimensions: AR-S - AR-CLS

Thread	M2, M2.5, M3				M3alt			M3.5			M4			
Code	-0	-1	-2	-3	-0	-1	-2	-0	-1	-2	-0	-1	-2	-3
D max	4.20				4.73			4.73			5.38			
B±0.2	6.35				7.1			7.1			7.95			
H±0.25	1.5				1.5			1.5			2.0			
h max	0.77	0.97	1.38	2.21	0.77	0.97	1.38	0.77	0.97	1.38	0.77	0.97	1.38	2.21
Min rec sheet thickness	0.8	1.0	1.4	2.3	0.8	1.0	1.4	0.8	1.0	1.4	0.8	1.0	1.4	2.3
Hole size +0.08/-0.00	4.22				4.75			4.75			5.41			
Min distance to edge of sheet	4.08				5.6			5.6			6.9			

Thread	M5				M6				M8			M10		M12
Code	-0	-1	-2	-3	0	-1	-2	-3	-1	-2	-3	-1	-2	-1
D max	6.33				8.73				10.47			13.97		16.95
B±0.2	8.75				11.10				12.65			17.35		20.55
H±0.25	2.0				4.08				5.47			7.48		8.5
h max	0.77	0.97	1.38	2.21	1.15	1.38	2.21	3.05	1.38	2.21	3.05	2.21	3.05	3.05
Min rec sheet thickness	0.8	1.0	1.4	2.3	1.2	1.4	2.3	3.2	1.4	2.3	3.2	2.31	3.18	3.18
Hole size +0.08/-0.00	6.35				8.75				10.5			14.0		17
Min distance to edge of sheet	7.1				8.6				9.7			13.5		16