

MS818-3B

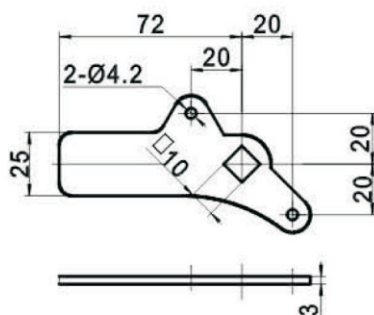
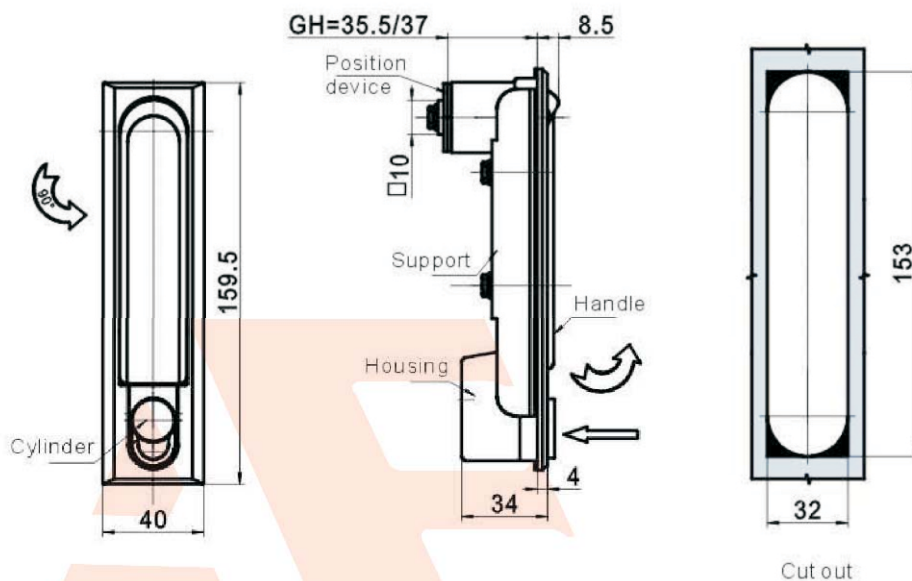

Default cam

Remarks:
Default cam as shown, cam and cylinder refer to MS818.
Others on request.

Main material and finish: Silver painted ZDC handle, housing; zinc-plated steel cam; bright chrome-plated ZDC profile Cylinder.

Remarks: Default cylinder insert TC04-1.

| | | |
|--------|---------------------------------------|-------------|
| TC06-1 | K29 | K29 |
| TC05-2 | K03, K04, K04-2, K05, K10-2, K11, K28 | K04 |
| TC05-1 | K03, K04, K04-2, K05, K10-2, K11, K28 | K04 |
| TC04-2 | | |
| TC04-1 | K03, K04, K04-2, K05, K10-2, K11, K28 | K04 |
| CODE | ADAPTED KEY | Default key |
| | SPECIFICATION | |