

CONDUIT & FITTINGS

Nylon Flexible Conduit

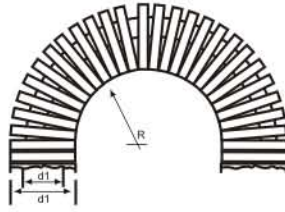

Model No.		Inner Diameter (d1)	Outer Diameter (d2)	Bending Radius (R) mm±10%	Packing meter/roll
Black	Gray				
ACS-07B	ACS-07G	6.4	10.0	15	50
ACS-10B	ACS-10G	9.6	13.0	20	50
ACS-12B	ACS-12G	11.8	15.8	30	50
ACS-16B	ACS-16G	15.9	21.2	40	50
ACS-22B	ACS-22G	21.7	28.5	45	50
ACS-28B	ACS-28G	27.8	34.5	55	50
ACS-36B	ACS-36G	36.0	42.5	60	30
ACS-48B	ACS-48G	46.5	54.5	70	30
ACS-56B	ACS-56G	56.3	67.2	110	30
ACS-70B	ACS-70G	70	82.5	160	10
ACS-95B	ACS-95G	91.5	106	210	10

Specifications :-

Material : Polyamide 6
 Construction : Inside & Outside Corrugated Plastic Hose
 Protection : IP 68 according EN 60529
 Temperature Range : -40 C to +105 C, Short Term +130 C
 Self Extinguishing : UL 94-HB, Helogen Free
 Connections : ACSFiX

Model No.	PG Thread	Fit to Conduit Size	Thread OD	Thread Length (C)	I mm	B mm	Length D	Wrench SW
AQC-07B	PG 7	ACS-07B	12.5	10	7	17	34.5	15
AQC-10B	PG 9	ACS-10B	15.2	9.5	10	20.2	36	18
AQC-12B	PG 11	ACS-12B	18.6	9.5	12	23.2	38	21
AQC-14B	PG 13.5	ACS-12B	20.4	11	14	26.2	40	24
AQC-16B	PG 16	ACS-16B	22.5	13	17	29.7	43.5	27
AQC-22B	PG 21	ACS-22B	28.3	13	23.5	37.4	48	34
AQC-28B	PG 29	ACS-28B	37	12	30	44	51	40
AQC-36B	PG 36	ACS-36B	47	14	36.5	52	54	48
AQC-48B	PG 48	ACS-48B	59.3	14.5	48	64	55	59

Quick Connector



Specification :-

Material : Polyamide 6
 Protection : IP 68 according EN 60529
 Temperature Range : -40 C to +105 C, Short Term +130 C
 Self Extinguishing : UL 94-HB, Helogen Free
 Certifications : CE, ROHS, PAHS

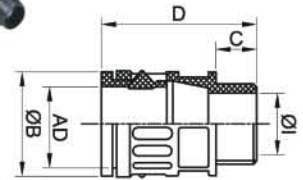

Quick Elbow Connector



Specification :-

Material : Polyamide 6
 Protection : IP 68 according EN 60529
 Temperature Range : -40 C to +105 C, Short Term +130 C
 Self Extinguishing : UL 94-HB, Helogen Free
 Certifications : CE, ROHS, PAHS

Model No.	PG Thread	Fit to Conduit Size	Thread Length (C)	I mm	B mm	Total Height D	Total Length E
AQE-07B	PG 7	ACS-07B	10	7	17	33.5	32
AQE-10B	PG 9	ACS-10B	10	8	20.2	36	34
AQE-12B	PG 11	ACS-12B	10	12	23.2	42	47
AQE-14B	PG 13.5	ACS-14B	11	14	26.2	45	44
AQE-16B	PG 16	ACS-16B	13	15.5	29.7	50	49
AQE-22B	PG 21	ACS-22B	13	18	37.5	57	56
AQE-28B	PG 29	ACS-28B	12	24	44	67.5	63
AQE-36B	PG 36	ACS-36B	12	32	52	83	70
AQE-48B	PG 48	ACS-48B	14	39	64	88	83

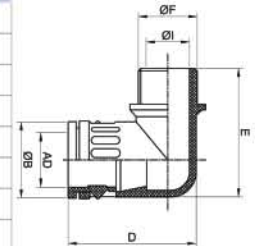

Model No.	PG Thread	Fit to Conduit Size	A	B	C	D	Fastening Bore hole
AQE-07B	PG 7	ACS-07B	12.5	25	20	6	4
AQE-10B	PG 9	ACS-10B	11.5	29.5	23.5	7.5	4
AQE-12B	PG 11	ACS-12B	12.5	30	23.5	7.8	4.5
AQE-14B	PG 13.5	ACS-14B	13.5	31.5	26	9	5
AQE-16B	PG 16	ACS-16B	15	35	30.5	9.5	5.5
AQE-22B	PG 21	ACS-22B	16	42	38	12	6.5
AQE-28B	PG 29	ACS-28B	16.5	51	43.5	12	6.5
AQE-36B	PG 36	ACS-36B	19	61	51	12	6.5
AQE-48B	PG 48	ACS-48B	19	73.5	64	12	6.5

Fixing Clip



Specification :

Material : Polyamide 6
 Temperature Range : -40 C to +105 C, Short Term : +130 C
 Self Extinguishing : UL 94-HB, Helogen Free
 Certifications : CE, ROHS, PAHS

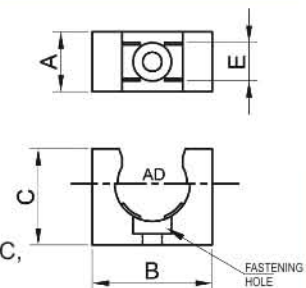

Y Connector

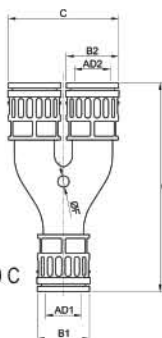

Specification :-

Material : Polyamide 6
 Protection : IP 68 according EN 60529
 Temperature Range : -40 C to +105 C, Short Term +130 C
 Self Extinguishing : UL 94-HB, Helogen Free
 Certifications : CE, ROHS, PAHS

Model No.	PG Thread	Fit to Conduit Size	AD 1	AD 2	Fastening Bore hole	Packing Unit
AYC-07B	PG 7	ACS-07B	PG 7	2 X PG 7	4.0	10
AYC-10B	PG 9	ACS-10B	PG 9	2 X PG 9	4.0	10
AYC-12B	PG 11	ACS-12B	PG 11	2 X PG 11	4.0	10
AYC-14B	PG 13.5	ACS-14B	PG 13.5	2 X PG 13.5	4.0	10
AYC-16B	PG 16	ACS-16B	PG 16	2 X PG 16	4.0	10
AYC-22B	PG 21	ACS-22B	PG 21	2 X PG 21	4.0	10
AYC-28B	PG 29	ACS-28B	PG 29	2 X PG 29	4.0	10
AYC-36B	PG 36	ACS-36B	PG 36	2 X PG 36	4.0	10
AYC-48B	PG 48	ACS-48B	PG 48	2 X PG 48	4.0	10